

P-Series

PUSHBUTTON SWITCHES

These rugged pushbutton-type switches feature international approvals, ratings to 20A 125VAC and a heavy actuation force (3-5 lbs. typical) which makes this switch ideal for use as a “foot-pedal” switch. The metal bushing and plunger construction enables this alternate action switch to withstand the rigors of most any stringent pushbutton application.



Product Highlights:

- Rugged metal clad construction ideal for foot pedal applications
- Ratings to 20A 125VAC
- UL, CSA and TUV approvals
- Maintained On-Off or On-ON circuitry

Typical Applications:

- Vacuum Cleaners



Carling Technologies®
Innovative Designs. Powerful Solutions.

Techna

www.techna.co.uk

Dielectric Strength

UL/CSA: 1000 - live to dead metal parts & opposite polarity
 TUV: 4000V - live to dead metal parts; 1250V - opposite polarity across open contacts

Electrical Life

50,000 cycles

Operating Temperature

0°F to 85°F (32°C to 85°C)

PA341

¹
 Part Number

1 PART NUMBER: SERIES / ACTUATOR / CIRCUITRY / RATING / TERMINATION

	.250 Tab	Screw Terms.	Wire Leads
10A 250VAC, 15A 125VAC, 3/4 HP 120-240 VAC ¹			
On-Off	PA341	PA344	PA345
On-On	PB341	PB344	PB345
10A 250VAC, 20A 125VAC, 1 1/2 HP 120-240 VAC ¹			
On-Off	PA301	PA304	PA305
On-On	PB301	PB304	PB305
10A 250VAC, 15A 125VAC, 10(6)a 250 VACu, T85 ²			
On-Off	PA951	PA954	PA955

Notes:

- 1 Additional ratings available. Consult factory.
- 2 UL, CSA & TUV approved.

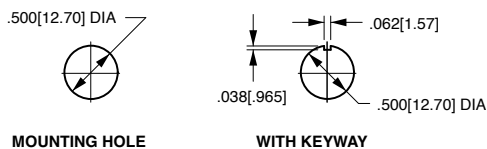
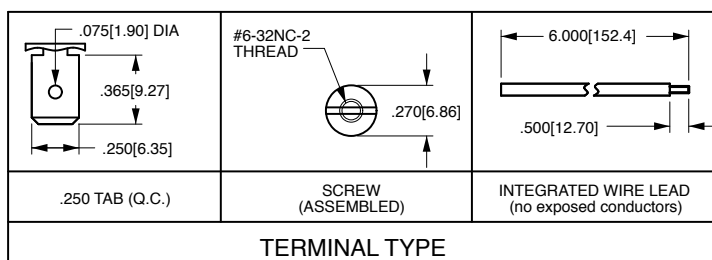
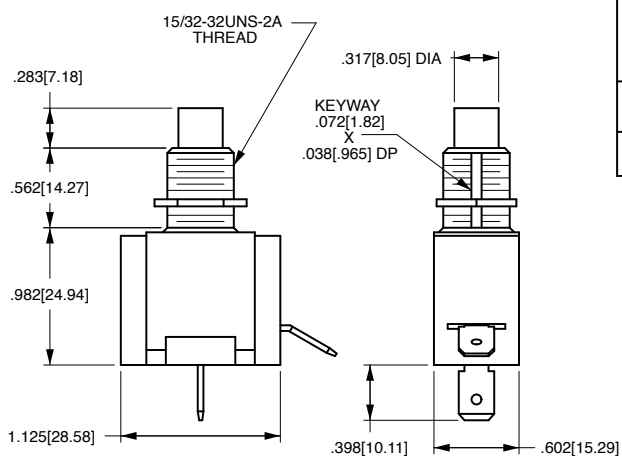

*Manufacturer reserves the right to change product specification without prior notice.